

NOTES:

- FOR INSTALLATION RECOMMENDATIONS REFER TO MAZZEI TECHNICAL BULLETINS No. 4, No. 5, No. 6, No. 10 AND 11, WHICH CAN BE FOUND AT WWW.MAZZEI.NET.

| REVISIONS |  |            |            |
|-----------|--|------------|------------|
| REV.      | DESCRIPTION                                | DATE       | APPROVED   |
| A         | RELEASED FOR SUBMITTAL                     | 6/11/18    | J. BENNETT |
| 0         | RE-RELEASED FOR SUB. - UPDATED DESCRIPTION | 12/12/2019 | J.M        |

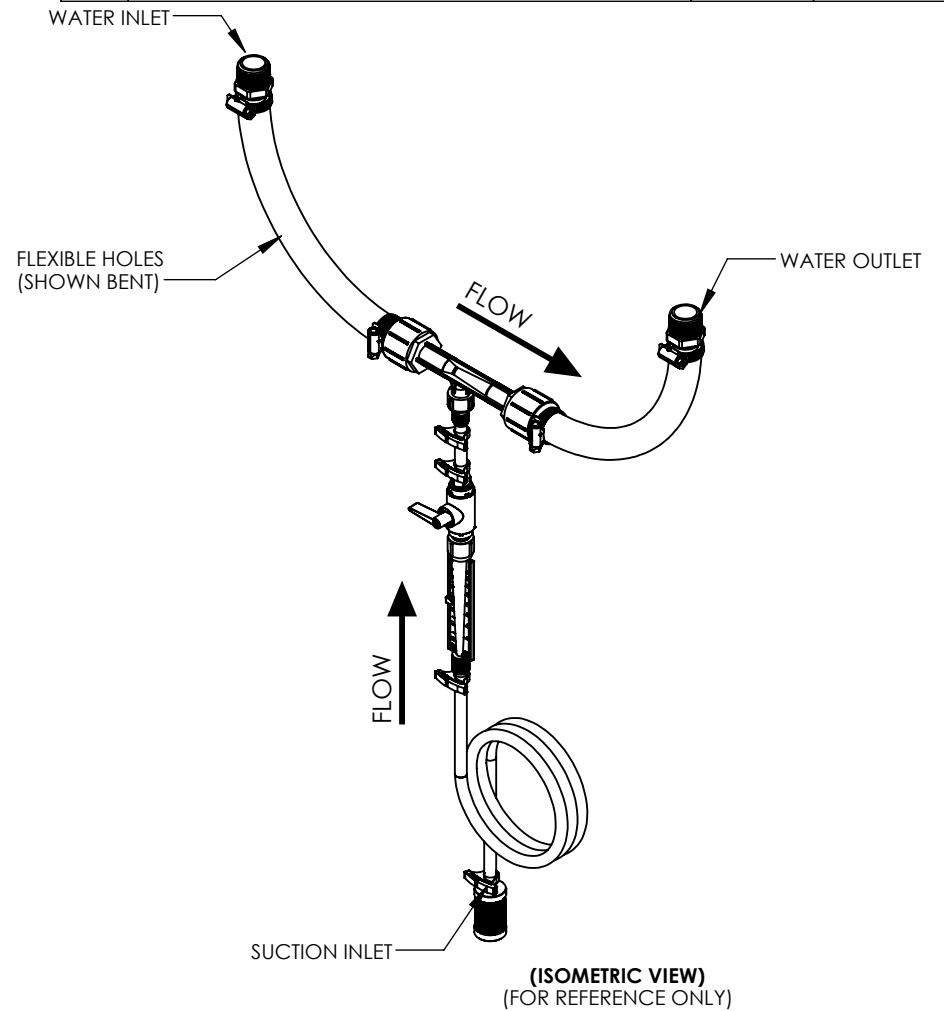

|   |              |   |   |        |        |
|---|--------------|---|---|--------|--------|
| UNLESS OTHERWISE SPECIFIED DIMENSIONS ARE IN INCHES |              |  | DESCRIPTION:<br>BYPASS ASSEMBLY KIT W/ INJECTOR;<br>K484A-B |        |        |
| DRAWN:  | J. MARASIGAN |   | DRAWING NO.:<br>K484A-B KIT                                 |        |        |
| DATE:   | 6/5/2018     | SIZE:   | WEIGHT:   | SCALE: | REV.:  |
| APPROVED:   | J. BENNETT   | A   | N/A   | 1:6    | 0      |
|   |              |   |   | SHEET: | 1 OF 2 |

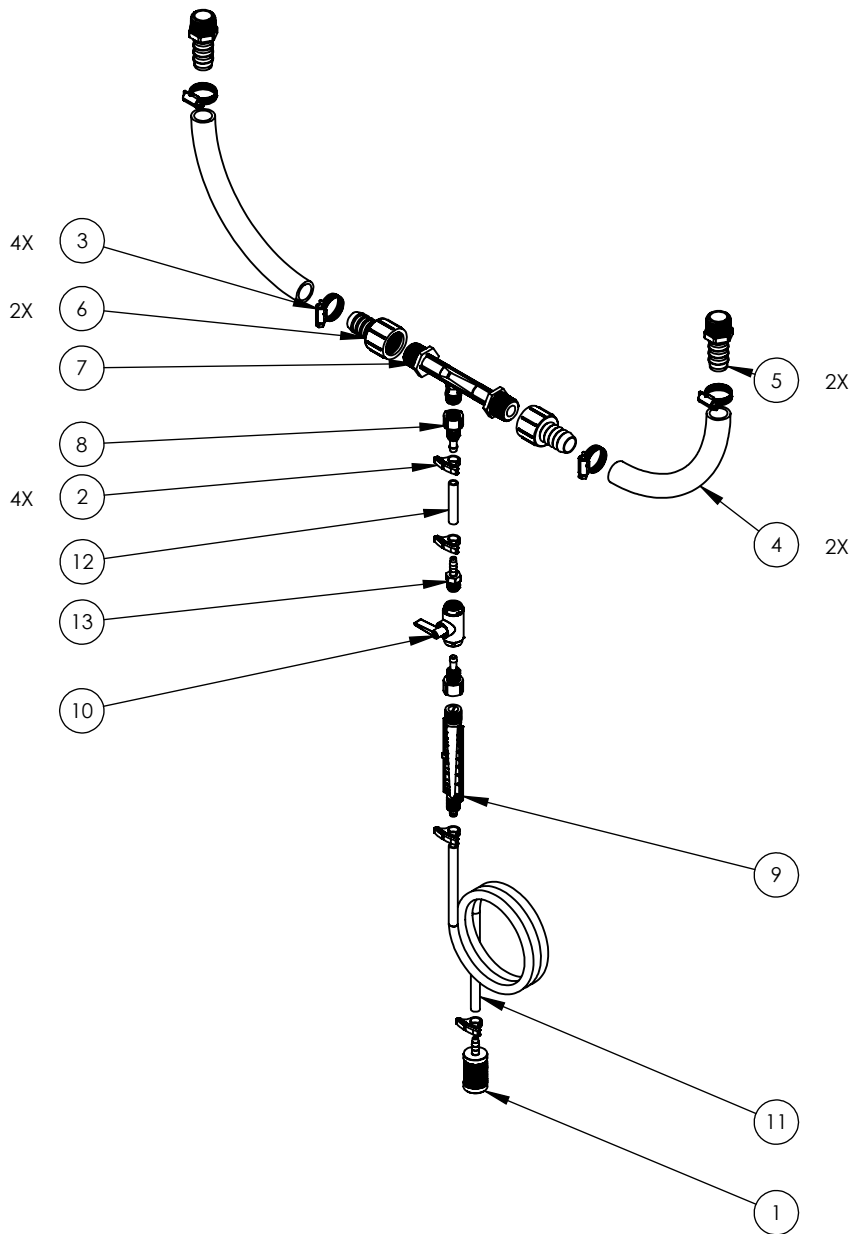

(EXPLODED VIEW)  
(FOR REFERENCE ONLY)

| ITEM NO. | TITLE          | PART NUMBER  | DESCRIPTION                                   | QTY |
|----------|----------------|--------------|---|-----|
| 1        | STRAINER       | S-25HB       | STRAINER; S-25HB                              | 1   |
| 2        | CLAMP          | CLAMP#23     | PLASTIC TUBE CLAMP                            | 4   |
| 3        | CLAMP          | 13H-12       | STAINLESS HOSE CLAMP, 3/4"                    | 4   |
| 4        | HOSE           | AG200 BLACK  | HIGH PRESSURE HOSE, 3/4" I.D. X 13"           | 2   |
| 5        | ADAPTER        | 1436-007     | ADAPTER, 3/4" MNPT X BARB                     | 2   |
| 6        | ADAPTER        | 1435-007     | ADAPTER; 3/4" FNPT X .5" INSERT               | 2   |
| 7        | INJECTOR       | 0484-A PP    | INJECTOR; 0484-A PP                           | 1   |
| 8        | CAP            | CAP-PP .375  | CAP; CAP-PP .375                              | 1   |
| 9        | FLOWMETER      | F-30 L       | FLOWMETER, 1/4" BARB, 5-40 GPH                | 1   |
| 10       | VALVE          | PBV5-4F-PP-E | BALL VALVE, 5/16" ORIFICE, 1/4" FNPT, PP EPDM | 1   |
| 11       | TUBING         | VT-025       | 1/4" ID x 3/8" x 6' OD CLEAR VINYL TUBING     | 1   |
| 12       | TUBING         | VT-025       | 1/4" I.D. x 3/8" O.D. X 2.00"                 | 1   |
| 13       | TUBING ADAPTER | TA-225       | ADAPTER; 1/4" MNPT X 1/4" BARB                | 1   |



DESCRIPTION:  
BYPASS ASSEMBLY KIT W/ INJECTOR;  
K484A-B

DRAWING NO.: K484A-B KIT

|                   |                |               |            |                  |
|-------------------|----------------|---------------|------------|------------------|
| SIZE:<br><b>A</b> | WEIGHT:<br>N/A | SCALE:<br>1:8 | REV.:<br>0 | SHEET:<br>2 OF 2 |
|-------------------|----------------|---------------|------------|------------------|