

NOTES:

- FOR INSTALLATION RECOMMENDATIONS REFER TO MAZZEI TECHNICAL BULLETINS No. 4, No. 5, No. 6, No. 10 AND 11, WHICH CAN BE FOUND AT WWW.MAZZEI.NET.

REVISIONS			
REV.	DESCRIPTION	DATE	APPROVED
A	RELEASED FOR SUBMITTAL	6/11/18	J. BENNETT
0	RE-RELEASED FOR SUB - UPDATED DESCRIPTION	12/12/2019	J.M.

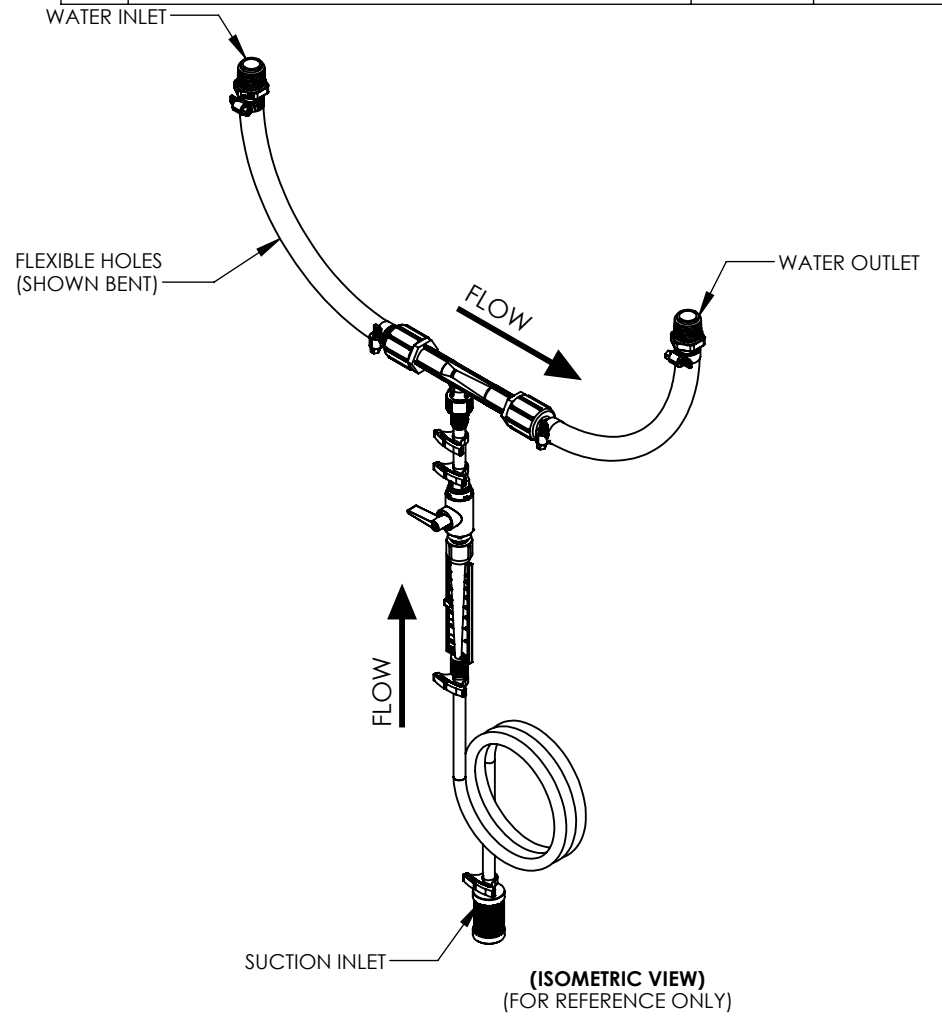

UNLESS OTHERWISE SPECIFIED DIMENSIONS ARE IN INCHES			DESCRIPTION: BYPASS ASSEMBLY KIT W/ INJECTOR; K384-B		
DRAWN:	J. MARASIGAN		DRAWING NO.: K384-B KIT		
DATE:	6/5/2018	SIZE:	WEIGHT:	SCALE:	REV.:
APPROVED:	J. BENNETT	A	N/A	1:6	0
				SHEET:	1 OF 2

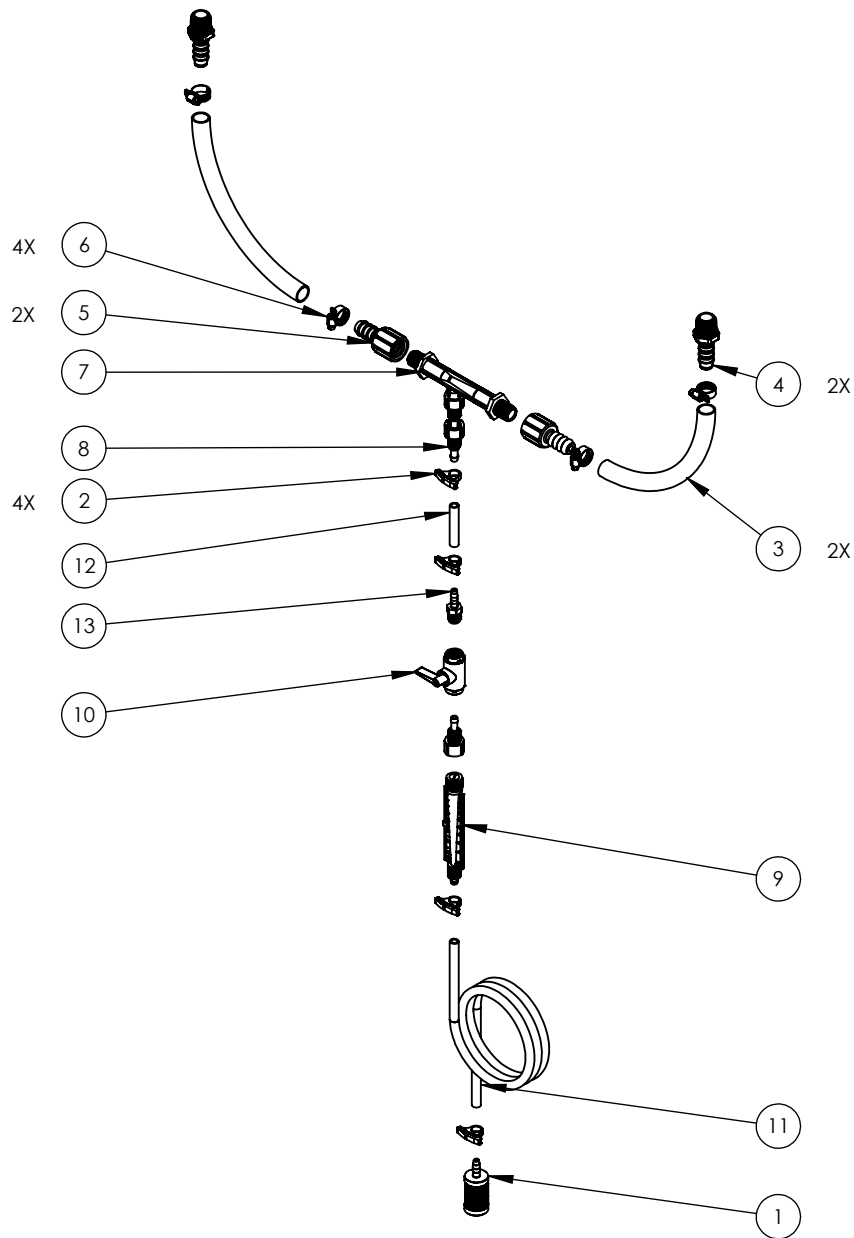

(EXPLODED VIEW)  
(FOR REFERENCE ONLY)

ITEM NO.	TITLE	PART NUMBER	DESCRIPTION	QTY
1	STRAINER	S-25HB	STRAINER; S-25HB	1
2	CLAMP	CLAMP#23	PLASTIC TUBE CLAMP	4
3	HOSE	AG200 BLACK	HIGH PRESSURE HOSE 1/2" I.D. x 16"	2
4	ADAPTER	1436-005	ADAPTER, 1/2" MNPT X BARB	2
5	ADAPTER	1435-005	ADAPTER, 1/2" FNPT X BARB	2
6	CLAMP	13H-08	STAINLESS HOSE CLAMP, 1/2"	4
7	INJECTOR	0484 PP	1/2" INJECTOR; 0484 PP	1
8	CAP	CAP-PP .375	CAP; CAP-PP .375	2
9	FLOWMETER	F-30 L	FLOWMETER, 1/4" BARB, 5-40 GPH	1
10	VALVE	PBV5-4F-PP-E	BALL VALVE, 5/16" ORIFICE, 1/4" FNPT, PP EPDM	1
11	TUBING	VT-025	1/4" ID x 3/8" x 6' OD CLEAR VINYL TUBING	1
12	TUBING	VT-025	1/4" I.D. x 3/8" O.D. X 2.00"	1
13	TUBING ADAPTER	TA-225	ADAPTER; 1/4" MNPT X 1/4" BARB	1



DESCRIPTION:  
BYPASS ASSEMBLY KIT W/ INJECTOR;  
K384-B

DRAWING NO.: K384-B KIT

SIZE: A	WEIGHT: N/A	SCALE: 1:8	REV.: 0	SHEET: 2 OF 2
------------	----------------	---------------	------------	------------------