

NOTES:

1. FOR INSTALLATION RECOMMENDATIONS REFER TO MAZZEI TECHNICAL BULLETINS No. 4, 5, 6, 10, AND 11, WHICH CAN BE FOUND AT WWW.MAZZEI.NET.
2. INJECTOR & HOSE BARB CAP NOT INCLUDED WITH BYPASS SUCTION KIT.

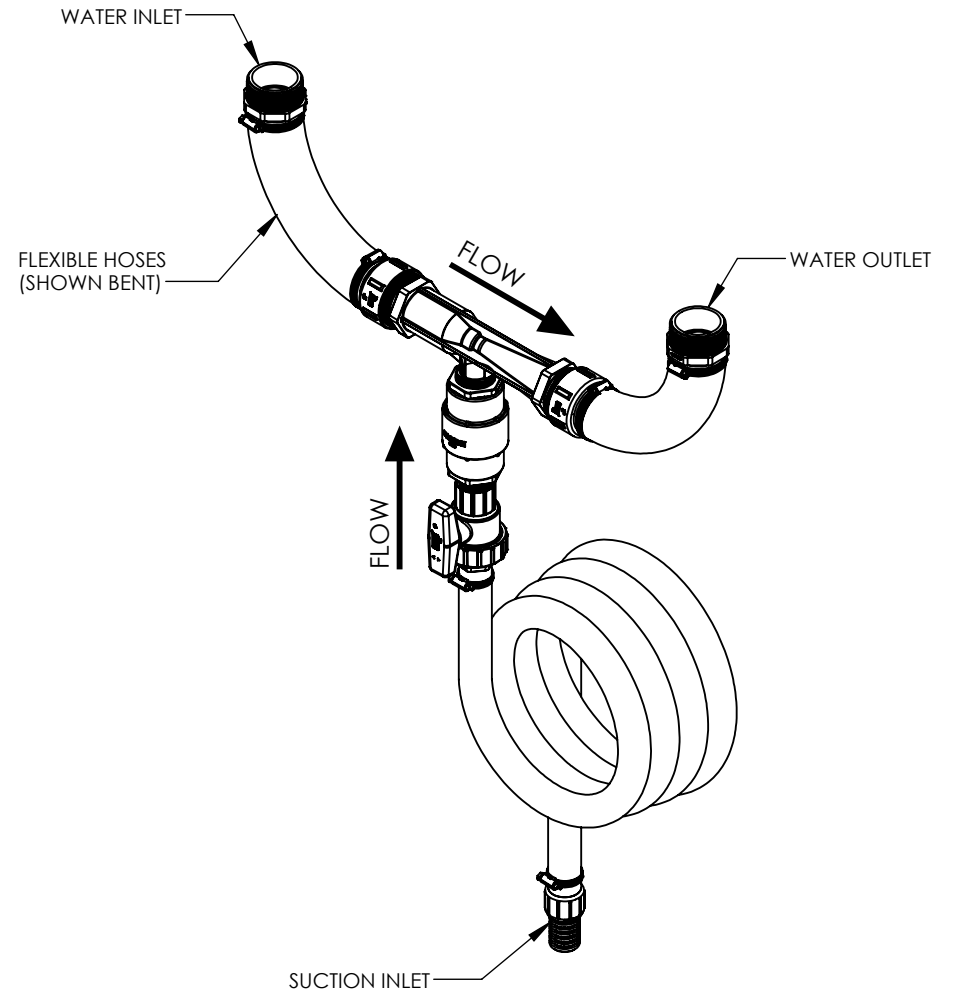

(ISOMETRIC VIEW)
(FOR REFERENCE ONLY)

UNLESS OTHERWISE SPECIFIED DIMENSIONS ARE IN INCHES			DESCRIPTION: KIT, BYPASS AND SUCTION LINE KIT ASSEMBLY FOR 2" INJ			
DRAWN: J. PEREZ	DATE: 6/9/2015		DRAWING NO.: K-282-A KIT			
APPROVED: T. JOHNS	SIZE: A	WEIGHT: N/A	SCALE: 1:8	REV.: NC	SHEET: 1 OF 2	

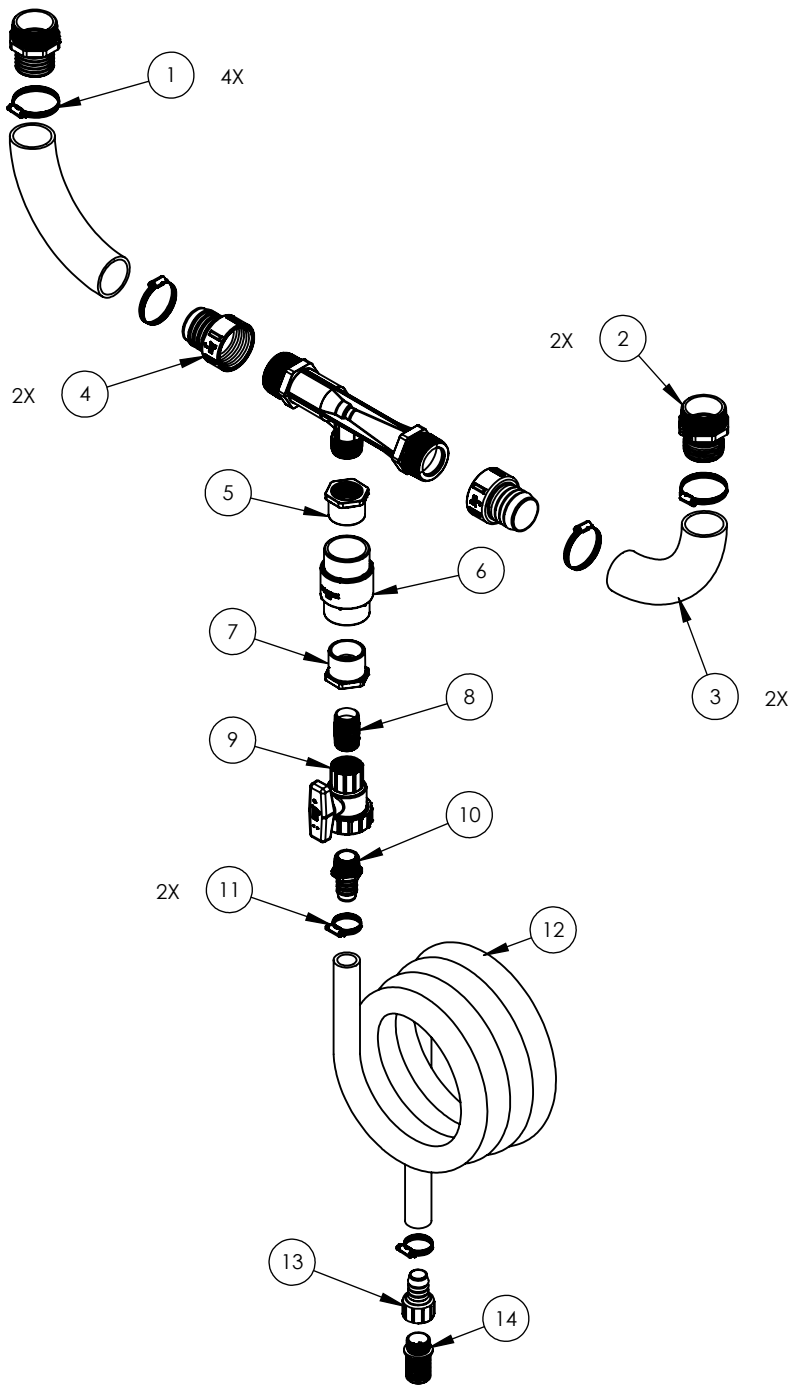

(EXPLODED VIEW)
(FOR REFERENCE ONLY)

ITEM NO.	TITLE	PART NUMBER	DESCRIPTION	QTY.
1	CLAMP	13H-32	STAINLESS HOSE CLAMP, 2"	4
2	ADAPTER	1436-020	ADAPTER, 2" MNPT X BARB	2
3	HOSE	AG200 BLACK	HIGH PRESSURE HOSE 2" I.D. x 19"	2
4	ADAPTER	1435-020	ADAPTER, 2" FNPT X BARB	2
5	ADAPTER	438-212G	BUSHING, 1-1/2" X 1-1/4", SPIG X FNPT	1
6	CHECK VALVE	0830-15C	CLEAR CHECK VALVE, 1-1/2" SOC/2" SPIG, 1/4 LB	1
7	ADAPTER	438-211G	BUSHING, 1-1/2" X 1", SPIG X FNPT	1
8	NIPPLE	884-020	NIPPLE, 1" X 2", MNPT	1
9	VALVE	2431-010G	SINGLE ENTRY BALL VALVE, 1", FNPT, FKM	1
10	ADAPTER	1436-010	ADAPTER, 1", MNPT X INSERT	1
11	CLAMP	13H-16	STAINLESS HOSE CLAMP, 1"	2
12	VINYL TUBING	VT-010	1" I.D. x 1-3/8" O.D. x 10 FT. (COILED)	1
13	ADAPTER	1435-010	ADAPTER, 1", FNPT X INSERT	1
14	STRAINER	1800-10	STRAINER, 1", MNPT, #6 MESH	1

UNLESS OTHERWISE SPECIFIED
DIMENSIONS ARE IN INCHES

DRAWN: J. PEREZ

DATE: 6/9/2015

APPROVED: T. JOHNS



SIZE:
A

WEIGHT:
N/A

SCALE:
1:10

REV.:
NC

SHEET:
2 OF 2

DESCRIPTION:
KIT, BYPASS AND SUCTION LINE KIT
ASSEMBLY FOR 2" INJ

DRAWING NO.:
K-282-A KIT